



PARK & RECREATION ADVISORY COMMITTEE MEETING

Tuesday, April 8, 2025 at 5:00 p.m.
Caledonia Village Hall - 5043 Chester Lane
Caledonia, WI 53402

1. **Meeting Called to Order.**
2. **Approval of Minutes:** Parks and Recreation Advisory Committee – March 11, 2025
3. **Public Comment** – Provides a two-minute opportunity for citizens to voice opinions to the Park & Recreation Advisory Committee. The Committee cannot respond as this may conflict with open meeting requirements.
4. **New Business**
 - A. Review and Discuss Crawford Park Expansion Phase III Bid Results.
 - B. Review and Discuss Future Crawford Park Phasing.
 - C. Review Gorney Park Site Plan from the late 1990's.
5. **Continuing Business**
 - A. Review and Discuss Gorney Park Dog Park History.
6. **Adjournment**

**Park & Recreation Advisory Committee Meeting
March 11, 2025**

1 - Order

Meeting called to order by Trustee McManus at 5:30 p.m.

PRESENT: 5 – Trustee McManus, Trustee Lambrecht, Eugene Pagel, Christian De Jong, Tom Dovorany, Ian Dart

ABSENT: 1 –Larry Pedrazoli (unexcused)

STAFF/OTHER: Village Engineer Ryan Schmidt, Development Director Pete Wagner, Trustee Dale Stillman, Trustee Fran Martin, Trustee Lee Wishau, Jeremy Holm (Angels Youth Softball)

2 – Approval of Minutes from February 11, 2025

Motion to approve the Minutes from February 11th, 2025, made by Eugene Pagel. Seconded by Christian De Jong. Motion carried unanimously.

3 - Public comment –

The following people appeared to speak before the Committee:
None

4 – New Business

A. Review and Discuss Angels Youth Softball Park Use Agreement for Crawford Park

Staff presented a memorandum and summarized the Angels Youth Organization request to use Crawford Park for the second year in a row. Jeremy Holm, representing Angels Youth Softball Organization, spoke about the organization and that he has had a good relationship with Caledonia.

Motion was made by Eugene Pagel to recommend to the Village Board to approve the Park Use Agreement for Angels Youth Softball. Seconded by Christian De Jong. All aye.

B. Review and Discuss Gorney Dog Park History.

Trustee McManus presented some history of a proposed Dog Park at Gorney Park in conjunction with Trustee Wishau and Trustee Martin. Staff added history and a date at which the motion was denied at the Village Board. Staff recommended that other ideas have been brought forward for Gorney Park as part of the Park and Open Space Plan and that legal advice should be sought for how to bring back an item that has already been denied.

Motion was made by Christian De Jong to postpone the item to the April meeting. Seconded by Eugene Pagel. All aye.

C. Review Rochester Lateral Route for Oak Creek Power Plant Upgrade

Staff updated the Committee on a potential route for a buried gas pipeline to feed the Oak Creek Power Plant and the easement being requested by We Energies on Village Property. Minor Discussion amongst the Committee and Staff. If the route is chosen, the Village will be compensated. No motion required.

5 – Continuing Business

A. None.

6 – Adjournment

Trustee McManus adjourned the meeting at 5:55pm with no more items on the agenda.

2025-02 Crawford Park Expansion Phase III				Payne & Dolan		Poblocki Paving	
Item	Description	Unit	Est. Quantity	Unit Cost	Total Price	Unit Cost	Total Price
1	Furnish, Install, & Maintain Erosion Control	LS	1	\$ 5,000.00	\$ 5,000.00	\$ 10,000.00	\$ 10,000.00
2	Topsoil, Strip, and Stockpile	SY	12,000	\$ 1.77	\$ 21,240.00	\$ 4.30	\$ 51,600.00
3	Common Excavation	CY	3,200	\$ 9.00	\$ 28,800.00	\$ 72.00	\$ 230,400.00
4	Furnish & Install Dense Aggregate Base 1-1/4"	TON	6,375	\$ 27.75	\$ 176,906.25	\$ 48.00	\$ 306,000.00
5	HMA Pavement Surface (5 LT 58-28 S)	TON	851	\$ 115.00	\$ 97,865.00	\$ 117.00	\$ 99,567.00
6	HMA Pavement Binder (3 LT 58-28 S)	TON	1035	\$ 125.00	\$ 129,375.00	\$ 113.00	\$ 116,955.00
7	Remove and Replace 10' HMA Path	SY	940	\$ 40.00	\$ 37,600.00	\$ 39.00	\$ 36,660.00
8	8' HMA Path	SY	580	\$ 29.00	\$ 16,820.00	\$ 37.00	\$ 21,460.00
9	HMA Speed Hump	EA	2	\$ 1,750.00	\$ 3,500.00	\$ 2,000.00	\$ 4,000.00
10	Concrete 4" Sidewalk	SF	1,930	\$ 7.40	\$ 14,282.00	\$ 13.00	\$ 25,090.00
11	Concrete 6" Sidewalk	SF	1,630	\$ 7.60	\$ 12,388.00	\$ 15.00	\$ 24,450.00
12	Concrete Pavement (6" Depth)	SY	70	\$ 60.75	\$ 4,252.50	\$ 171.00	\$ 11,970.00
13	Concrete 18" Curb and Gutter	LF	118	\$ 35.50	\$ 4,189.00	\$ 75.00	\$ 8,850.00
14	Concrete 30" Curb and Gutter	LF	1788	\$ 21.75	\$ 38,889.00	\$ 30.00	\$ 53,640.00
15	Concrete Thickened Edge Walk	SY	325	\$ 120.75	\$ 39,243.75	\$ 153.00	\$ 49,725.00
16	Concrete Flume	EA	2	\$ 909.25	\$ 1,818.50	\$ 1,000.00	\$ 2,000.00
17	Concrete Pedestrian Curb	LF	30	\$ 35.50	\$ 1,065.00	\$ 85.00	\$ 2,550.00
18	Detectable Warning Fields	SF	160	\$ 55.56	\$ 8,889.60	\$ 60.00	\$ 9,600.00
19	Swing Gate	LS	1	\$ 3,867.00	\$ 3,867.00	\$ 7,259.00	\$ 7,259.00
20	Fencing & Gates (4' and 8')	LS	1	\$ 63,610.00	\$ 63,610.00	\$ 91,903.00	\$ 91,903.00
21	Pickleball Nets, Posts, and Center Anchors	LS	1	\$ 14,751.00	\$ 14,751.00	\$ 23,729.00	\$ 23,729.00
22	Pickleball Court Color Coating and Lining	LS	1	\$ 51,000.00	\$ 51,000.00	\$ 32,000.00	\$ 32,000.00
23	Basketball Court Lining & Hoops	LS	1	\$ 15,750.00	\$ 15,750.00	\$ 32,000.00	\$ 32,000.00
24	Storm Sewer 12"(granular backfill)	LF	123	\$ 75.76	\$ 9,318.48	\$ 119.00	\$ 14,637.00
25	Storm Sewer 15" (granular backfill)	LF	29	\$ 90.91	\$ 2,636.39	\$ 130.00	\$ 3,770.00
26	Storm Sewer RCP 12" Class V (granular backfill)	LF	107	\$ 95.96	\$ 10,267.72	\$ 202.00	\$ 21,614.00
27	Storm Sewer RCP 15" Class V (granular backfill)	LF	143	\$ 90.91	\$ 13,000.13	\$ 208.00	\$ 29,744.00
28	Precast Concrete 24"x36" Storm Inlet	EA	3	\$ 5,353.54	\$ 16,060.62	\$ 3,700.00	\$ 11,100.00
29	Precast Concrete 48" Storm Inlet	EA	2	\$ 4,444.45	\$ 8,888.90	\$ 5,800.00	\$ 11,600.00
30	Core into Existing Structure	EA	2	\$ 1,010.10	\$ 2,020.20	\$ 724.00	\$ 1,448.00
31	Remove Existing Storm Sewer	LS	1	\$ 505.05	\$ 505.05	\$ 10,000.00	\$ 10,000.00
32	Restoration, Seeding, & Mulch	SY	3,300	\$ 3.50	\$ 11,550.00	\$ 8.00	\$ 26,400.00
33	Shade Tree	EA	31	\$ 600.00	\$ 18,600.00	\$ 900.00	\$ 27,900.00
Total Base Bid				\$ 883,949.09		\$ 1,409,621.00	
ALTERNATE BID							
A2	Topsoil, Strip, & Stockpile	SY	3,540	\$ 1.62	\$ 5,734.80	\$ 4.30	\$ 15,222.00
A3	Common Excavation	CY	1,050	\$ 9.25	\$ 9,712.50	\$ 44.00	\$ 46,200.00
A4	Furnish & Install Dense Aggregate Base 1-1/4"	TON	1,630	\$ 27.50	\$ 44,825.00	\$ 38.00	\$ 61,940.00
A5	HMA Pavement Surface (5 LT 58-28 S)	TON	317	\$ 125.00	\$ 39,625.00	\$ 117.00	\$ 37,089.00
A6	HMA Pavement Binder (3 LT 58-28 S)	TON	408	\$ 130.00	\$ 53,040.00	\$ 113.00	\$ 46,104.00
A30	Restoration, Seeding & Mulch	SY	342	\$ 3.50	\$ 1,197.00	\$ 8.00	\$ 2,736.00
Total Alternate Bid				\$ 154,134.30		\$ 209,291.00	
Bid Summary		Base Bid		\$ 883,949.09		\$ 1,409,621.00	
		Alt. Bid		\$ 154,134.30		\$ 209,291.00	
		Total Bid		\$ 1,038,083.39		\$ 1,618,912.00	

TOWN OF CALEDONIA GORNEY PARK SITE IMPROVEMENTS

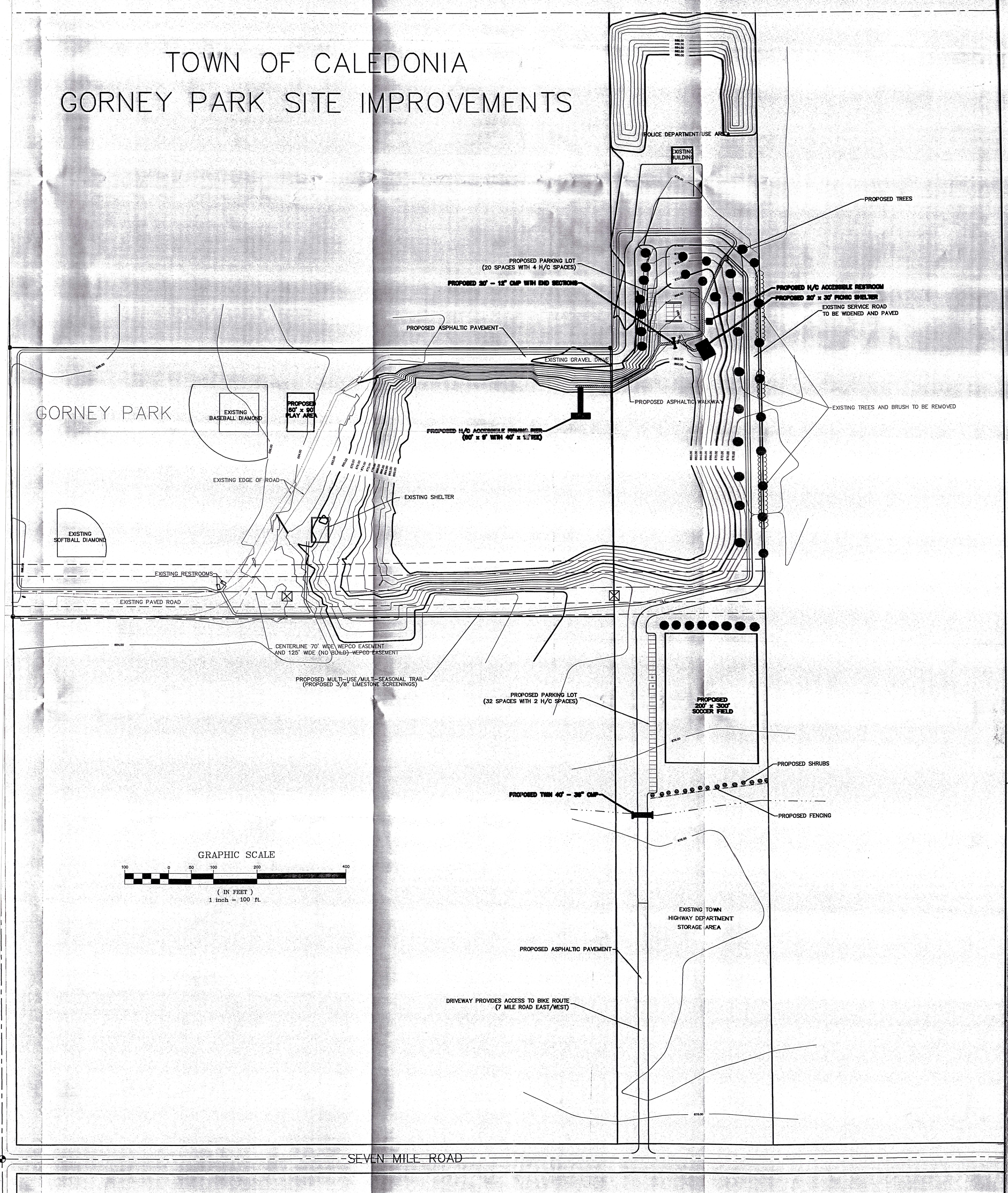

PROPOSED DOG PARK

at GORNEY PARK

DRAWN BY: CALEDONIA ENGINEERING

DATE DRAWN: 12-6-2022

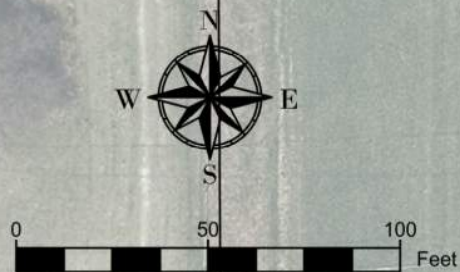

IMPROVE
CULVERT
CROSSING

PARKING LOT

PROP