

RESOLUTION 2024-022
(2/13/2024)

RESOLUTION OF THE VILLAGE BOARD OF THE VILLAGE OF CALEDONIA
ACCEPTING IMPROVEMENTS FOR THE CORONA DRIVE EXTENSION

The Village Board of the Village of Caledonia, Racine County, Wisconsin, resolves as follows:

RECITALS

1. The Village and the Richard & Diane Ruffo Revocable Trust dated 4/22/2009 (the "Developer") entered into a Development Agreement pertaining to the development of a Single-Family Residential Lot as part of the Corona Drive Extension (the "Development") with respect to the land described therein and certain public improvements, including Sanitary Sewer, Sanitary Sewer Lateral, Watermain, Water Lateral, Storm Water Facilities and the Road.

2. The work for the Development, including the Sanitary Sewer, Sanitary Sewer Lateral, Watermain, Water Lateral, Storm Water Facilities and the Road have been completed and have been inspected for compliance with the approved plans and specifications and is recommended by the Village's Public Services Director that the work for the public improvements for the Development be accepted by the Village Board subject to the following conditions:

- a. Village Board acceptance and approval.

NOW THEREFORE BE IT RESOLVED THAT, the certain public improvements, including the Sanitary Sewer, Sanitary Sewer Lateral, Watermain, Water Lateral, Storm Water Facilities and the Road are hereby accepted by the Village Board subject to the conditions recommended by the Village's Public Services Director as set forth above.

Adopted by the Village Board of the Village of Caledonia this 13 day of February 2024.

VILLAGE OF CALEDONIA

By: Thomas R. Weatherston
Thomas Weatherston, President

Attest: Jennifer Olsen
Jennifer Olsen, Clerk

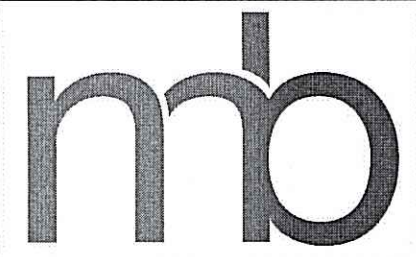

Nielsen Madsen + Barber
CIVIL ENGINEERS AND LAND SURVEYORS

1458 Horizon Blvd. Suite 200, Racine, WI. 53406
Tele: (262)634-5588 Website: www.nmbasc.net

CONSTRUCTION PLANS
for
BUCKLEY ROAD EXTENSION
for
DONALD AND JANE CHRISTENSEN
Village of Caledonia, Racine County, Wisconsin

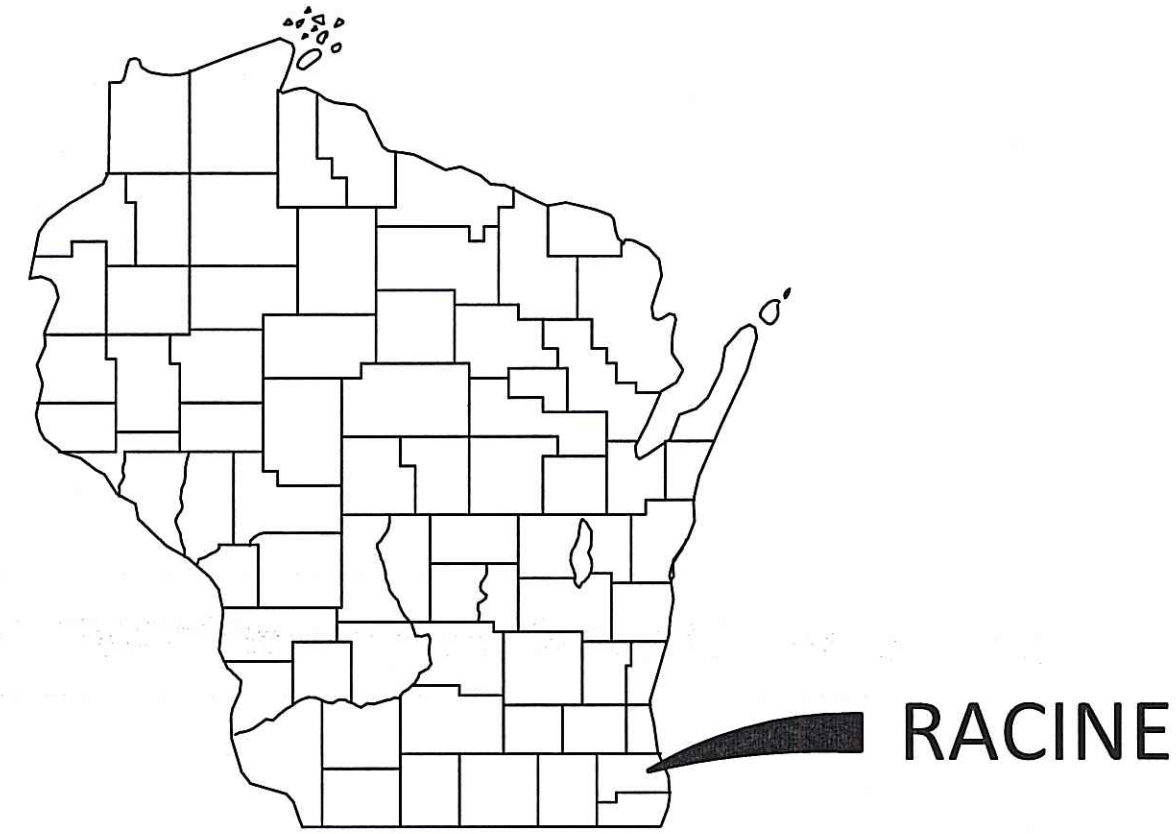

SHEET INDEX

Plan Sheet	Sheet No.
TITLE SHEET	C-1
EXISTING CONDITIONS MAP	C-2
DIMENSIONED SITE PLAN	C-3
SITE DEMOLITION PLAN	C-4
SITE GRADING & EROSION CONTROL PLAN	C-5
MASTER UTILITY PLAN	C-6
ROAD PLAN & PROFILE	C-7
TYPICAL SECTIONS & CONSTRUCTION DETAILS	C-8 & C-9

CLIENT

DONALD AND JANE CHRISTENSEN
4413 NORTHWESTERN AVENUE
RACINE, WI 53405

GOVERNING AGENCY CONTACTS

VILLAGE OF CALEDONIA
PETER WAGNER
DEVELOPMENT DIRECTOR
OFFICE: 262-835-6446
EMAIL: pwagner@caledonia-wi.gov

TONY BUNKELMAN, P.E.
UTILITY DIRECTOR
OFFICE: 262-835-6416
EMAIL: abunkelman@caledonia-wi.gov

RYAN SCHMIDT, P.E.
PUBLIC WORKS DIRECTOR
OFFICE: 262-835-6475
EMAIL: rschmidt@caledonia-wi.gov

PUBLIC UTILITY CONTACTS

AT&T
MIKE TOYEK
OFFICE: 262-636-0549
EMAIL: mt1734@att.com

TDS TELECOM
SOUTHEAST WISCONSIN
OFFICE: 877-483-7142

SPECTRUM
ROBERT TUNUTA
UTILITY COORDINATOR
OFFICE: 414-277-4205
CELL: 414-758-5688
EMAIL: tunuta@charter.net

WE-ENERGIES
ALLIE MILLER
KENOSHA SOUTH
OFFICE: 262-552-3227
EMAIL: allie.miller@we-energies.com

NATURAL GAS EMERGENCY:
(800) 261-5325

ELECTRICAL EMERGENCY:
(800) 662-4797

LEGEND

Description	Existing	Description	Existing	Proposed
EDGE OF WOODS		WATER SHUT OFF		
DECIDUOUS TREE		WATER MAIN VALVE		
DECIDUOUS TREE REMOVAL		HYDRANT		
CONIFEROUS TREE		WATER MAIN REDUCER		
CONIFEROUS TREE REMOVAL		SANITARY MANHOLE		
BUSH		SANITARY CLEAN OUT		
SOIL BORING		STORM MANHOLE		
TELEPHONE BOX		CATCH BASIN		
GUY WIRE		LIGHT POLE		
UTILITY POLE		ENDWALL		
GAS VALVE		STORM SEWER		
GAS METER		SANITARY SEWER		
SEPTIC VENT		WATERMAIN		
ELECTRIC MANHOLE		CONTOURS		
COMMUNICATION MANHOLE		FIRE PROTECTION		
WATER MANHOLE		UTILITY CROSSING		
HVAC UNIT		DITCH OR SWALE		
UNDERGROUND VAULT		CULVERT		
SECTION CORNER		RAILROAD TRACKS		
MAIL BOX		FENCE		
GUARD POST		NO VEHICULAR ACCESS		
STREET SIGN		UNDERGROUND ELECTRIC		
ELECTRIC PEDESTAL		UNDERGROUND GAS MAIN		
ELECTRIC METER		UNDERGROUND COMMUNICATIONS		
PAD MOUNT TRANSFORMER		SILT FENCE		
FOUND IRON PIPE		OVERHEAD ELECTRIC		
SET IRON PIPE		FORCE MAIN		
DRY WELL				

ABBREVIATIONS

BASE LINE	BL	INVERT ELEVATION	IE
LONG CORD OF CURVE	CHD	LENGTH OF CURVE	ARC
CURB AND GUTTER	C&G	MANHOLE	MH
CATCH BASIN	CB	NORMAL WATER LEVEL	NWL
CENTERLINE	CL	POINT OF CURVATURE	PC
EDGE OF PAVEMENT	EOP	POINT OF TANGENCY	PT
FINISHED FIRST FLOOR	FFF	TANGENCY OF CURVE	TAN
FINISHED GRADE	FG	POINT OF VERTICAL INTERSECTION	PVI
FLOW LINE	FL	RADIUS	R
FLOODPLAIN	FP	RIGHT OF WAY	ROW
ORDINARY HIGH WATER MARK	OHWM	SANITARY SEWER	SAN
TOP OF BANK	TOB	STORM SEWER	STM
TOP OF CURB	TOC	TOP OF FOUNDATION	TOF
TOP OF WALK	TOW	WATER MAIN	WM

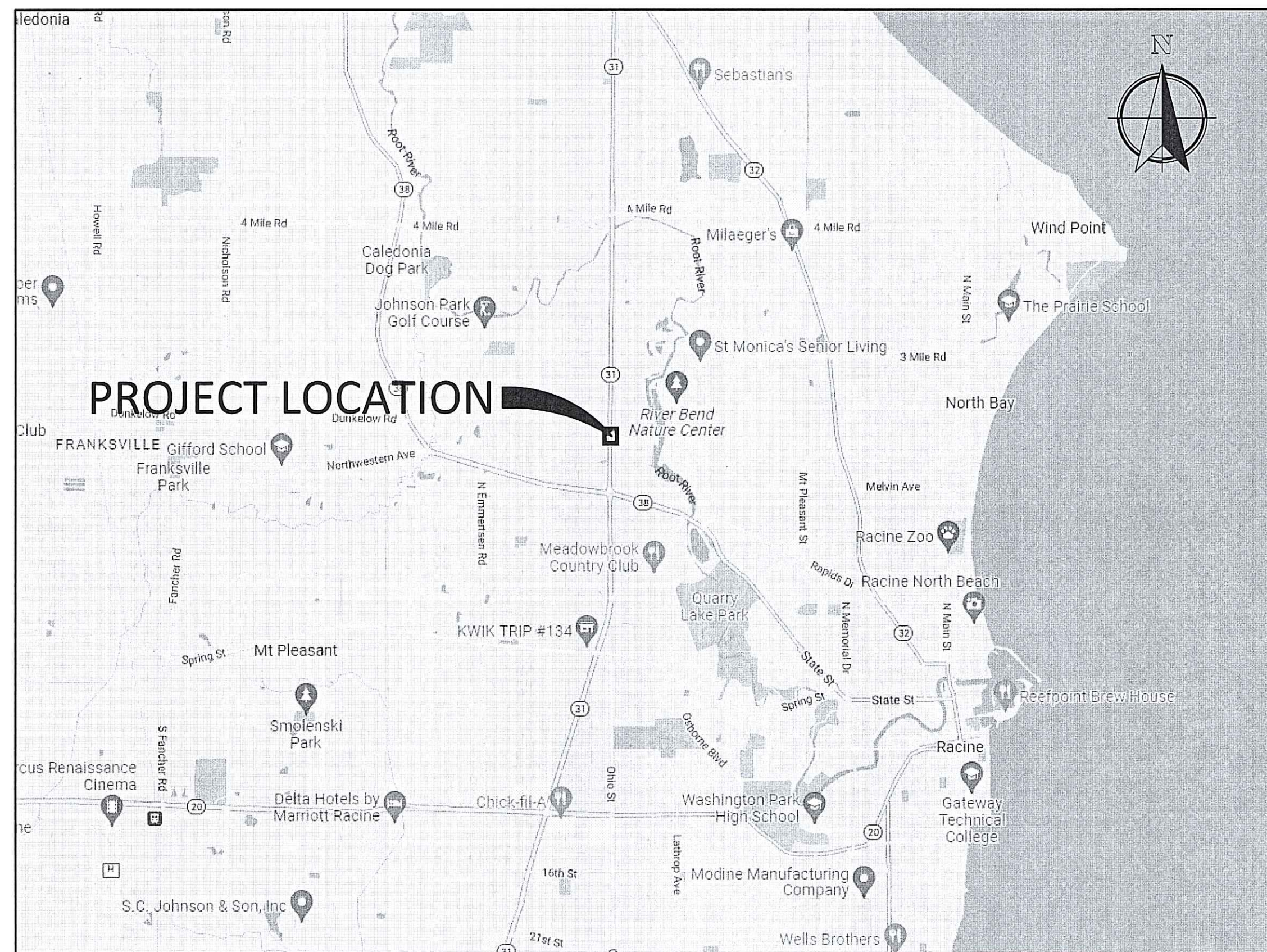

UTILITY NOTE

EXISTING UTILITIES ARE SHOWN FOR INFORMATIONAL PURPOSES ONLY AND ARE NOT GUARANTEED TO BE ACCURATE OR ALL INCLUSIVE. CONTRACTOR IS RESPONSIBLE FOR VERIFYING THE TYPE, LOCATION, SIZE AND ELEVATION OF UNDERGROUND UTILITIES AS THEY DEEM NECESSARY FOR PROPOSED UTILITY CONNECTIONS AND / OR TO AVOID DAMAGE THERETO, CONTRACTOR SHALL CALL DIGGERS HOTLINE PRIOR TO ANY CONSTRUCTION.

BENCH MARKS

1. LIGHTPOLE SPIKE
7" SPIKE OF SOUTHWEST FACING LIGHT POLE LOCATED
ELEVATION: 645.00



Mark R. Madsen
10-6-2022

BUCKLEY ROAD EXTENSION
CONSTRUCTION PLANS
FOR
DONALD AND JANE CHRISTENSEN
VILLAGE OF CALEDONIA, RACINE COUNTY, WISCONSIN

NO.	REVISION	BY	DATE

PROJ. MGR: MRM
DRAFTED: JWR
DATE: 9-30-2022
CHECKED: ALI
DATE: 10-3-2022

2022.0172.01

SHEET
C-1

ISSUE FOR APPROVAL: 10-6-2022

