



July 24, 2019

Project BRIEF

WIS 32 Stage 2 Scheduled to Begin

The Wisconsin Department of Transportation (WisDOT) is underway with reconstructing WIS 32 (Douglas Avenue). The project extends from just north of WIS 31 to just south of 5 Mile Road, and is scheduled to be complete late fall 2019.

As part of the reconstruction project, the upcoming work is scheduled for stage two:

Beginning Monday, August 5:

WIS 32 (Douglas Avenue), between WIS 31 and just south of 5 Mile Road, is scheduled to close long-term by 5:30 a.m.

- Due to the box culvert work, access will be restricted to WIS 32 from Harvest Lane and Matthew Drive.
- Residential access will only be available from WIS 31 or Middle Road. Traffic for local businesses will be maintained throughout the closure.

Detour Route:

- Travelers can use WIS 31, and 4 Mile Road to get around the WIS 32 (Douglas Avenue) closure.

Other work will include:

- Traffic signal at WIS 32 and 6 Mile Road to be replaced.
- A new traffic signal installed at WIS 31 and WIS 32.

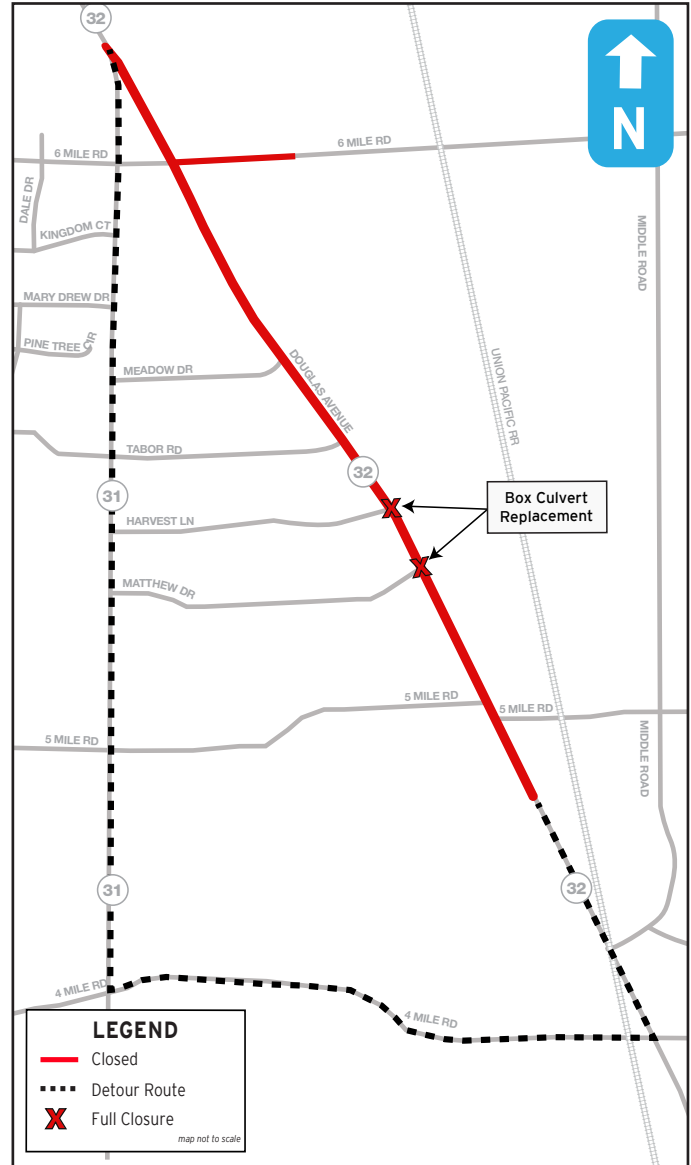

Please note that all closures are weather dependent and subject to change.

The project teams thanks you for your patience and cooperation throughout this project!



projects.511wi.gov/

For project information or to receive project updates, contact:
WIS 32 Public Involvement Contact: Rachel Andreoli
Email: Rachel@devorpr.com | Cell: (262) 977-0234