



Project BRIEF

February 1, 2019

I-94 North-South Freeway Project information

I-94 North-South (North Segment) Traffic Switch

The Wisconsin Department of Transportation (WisDOT) is reconstructing I-94 North-South (North Segment) from County G in Racine County north to College Avenue in Milwaukee County. All lanes will be open by Memorial Day 2020.

As part of the next phase of the project, crews will work to construct the new I-94 EAST (SB) lanes between Ryan Road and County G. This work will require all traffic to be shifted to the east, crossed over to the current northbound side of I-94. The southbound ramps at Seven Mile Road will also be closed and reconstructed at this time.

The following work and closures are scheduled to begin overnight Saturday, February 2:

- All traffic on I-94 North-South, between Ryan Road and County G, is scheduled to be crossed over to the current northbound side of I-94 through summer 2019. Three lanes will be maintained in each direction.
- I-94 EAST (SB) exit ramp to Seven Mile Road scheduled to close through summer 2019.
- Seven Mile Road entrance ramp to I-94 EAST (SB) scheduled to close through summer 2019.

Detour route: Motorists are encouraged to use Ryan Road, Seven Mile Road, County G, West Frontage Road, 27th Street, East Frontage Road and WIS 38 to get around the ramp and crossroad closures.

The speed limit on I-94 has been reduced to 60 mph.

Please note that all closures are weather dependent and subject to change.

To learn more about the upcoming construction or to receive project updates, please contact:

Rachel Andreoli
Construction Public Involvement Lead
Email: Rachel@devorpr.com
Phone: (262) 977-0234

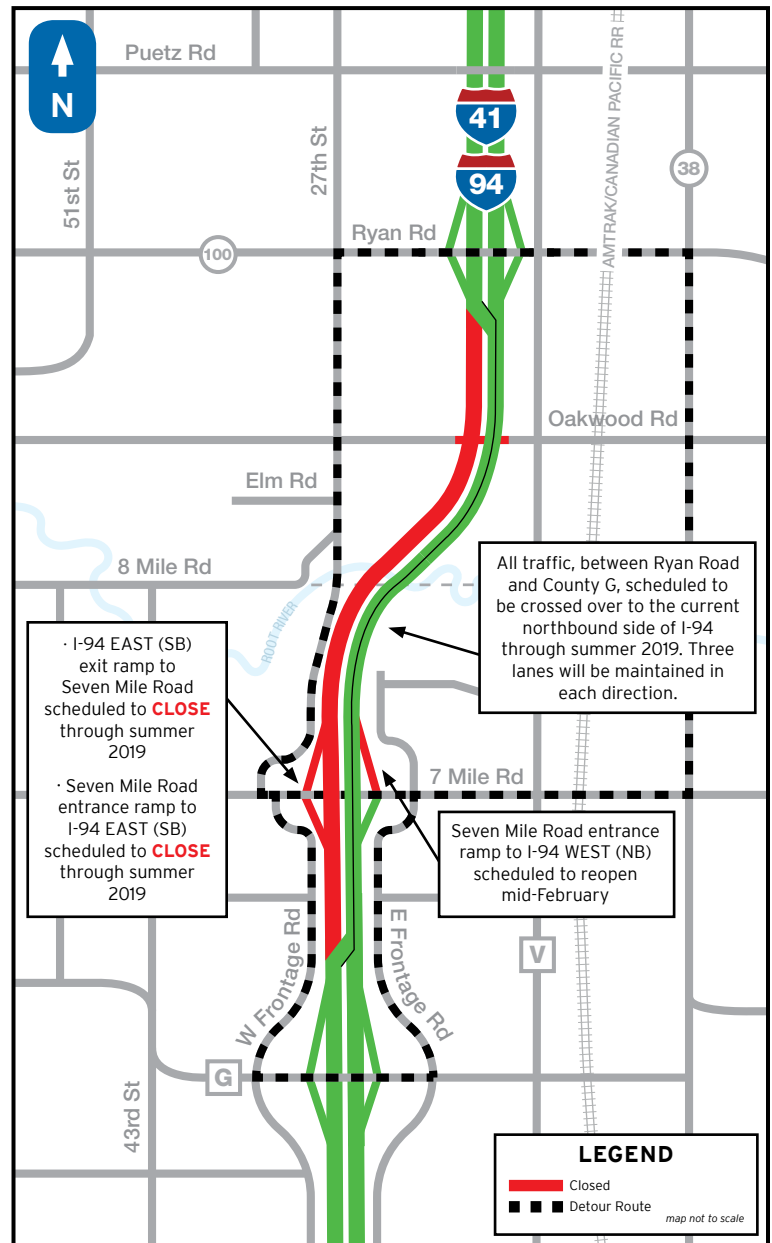

The project team thanks you for your patience and cooperation throughout this project!



Find us online at:
projects.511wi.gov



Find us on Facebook at:
Wisconsin Plan 94



Find us on Twitter at:
@WisconsinPlan94



Plan Ahead, Drive Safely, Move Forward